

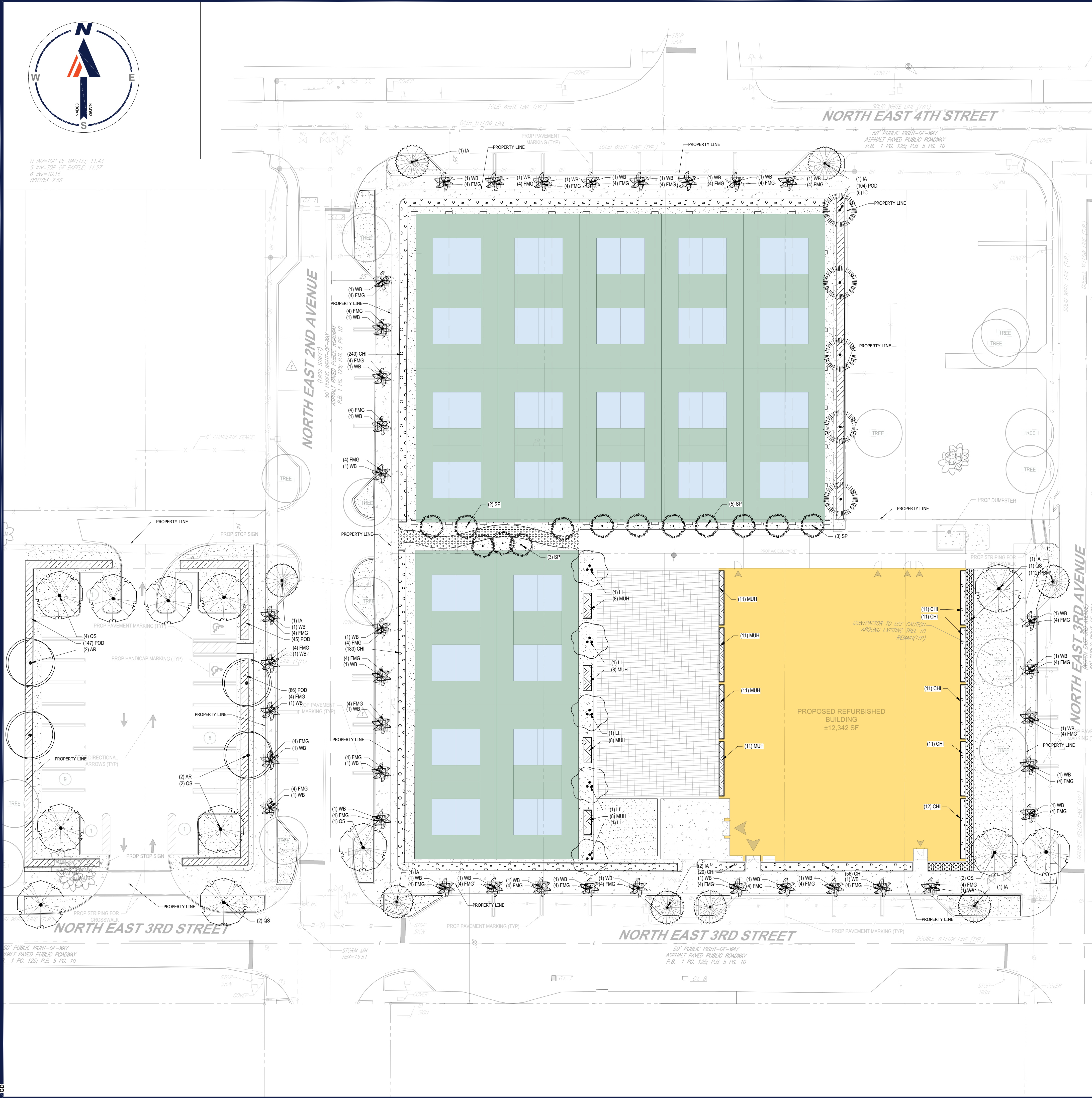

N IN=10' OF BATTLE: 11.57  
S IN=10' OF BATTLE: 11.57  
W IN=10.16  
BOTTOM=7.56



PLANT SCHEDULE								
SYMBOL	CODE	QTY	BOTANICAL NAME	COMMON NAME	SIZE	CONTAINER	NATIVE	DROUGHT
TREES								
AR	4	4	ACER RUBRUM	RED MAPLE	7" CAL. 14'-16" HT. CA. X 5" DB	CONT./B&B	NATIVE	TOLEANT
IA	8	8	ILEX ATTENUATA EAST PALATKA	EAST PALATKA HOLLY	7" CAL. 10'-12" CA. HT. X 5" DB	CONT./B&B	NATIVE	TOLEANT
C	5	5	ILEX CASABINE	DAKOTA HOLLY	7" CAL. 10'-12" CA. HT. X 5" DB	CONT./B&B	NATIVE	TOLEANT
LI	5	5	LAGERSTROMIA INDICA X FAUREI NATCHEZ	NATCHEZ CHAPE MYRTLE MULTI-TRUNK	2.2" CAL. 10'-12" CA. HT. X 5" DB	CONT./B&B	NO	TOLEANT
OS	12	12	QUERCUS VIRGINIANA 'SKY CLIMBER'	SKY CLIMBER SOUTHERN LIVE OAK	7" CAL. 14'-16" HT. CA. X 5" DB	CONT./B&B	NATIVE	TOLEANT
PALMS								
SP	13	13	SABAL PALMETTO	CABBAGE PALMETTO	10'-12" CT.	FG	NATIVE	TOLEANT
WB	38	38	WODGETIA BURFORDIA	FOXTAIL PALM	6'-15" CT.	FG	NO	TOLEANT
SYMBOL	CODE	QTY	BOTANICAL NAME	COMMON NAME	SIZE	CONTAINER	NATIVE	DROUGHT TOLERANT
SHRUB AREAS								
CH	185	185	CHRYSTOBALUS CACAO	COCOA PALM	24" HT. X 24" SPED	CONTAINER	NATIVE	TOLEANT
FG	182	182	PIGOS MICROCARPA GREEN ISLAND	GREEN ISLAND FIG	24" HT. X 24" SPED	CONTAINER	NO	TOLEANT
MM	78	78	NEALAMBICCA CAPILLARIS	PINK MALEY GRASS	24" HT. X 24" SPED	CONTAINER	NATIVE	TOLEANT
PM	112	112	PHILODENDRON BURLA-MERCI	BURLE MARX PHLODENDRON	24" HT. X 24" SPED	CONTAINER	NO	TOLEANT
POD	180	180	PODOCARPUS MACROPHYLLUS DWARF PRINGLES	DWARF PRINGLES YEW PODOCARPUS	24" HT. X 24" SPED	CONTAINER	NO	TOLEANT
SOD								
POD	11,630 SF	11,630 SF	STENOCHORDON PALMETTO	PALMETTO ST. AUGUSTINE GRASS	FULL, TIGHT COVERAGE	PALLET		

TM

**BOHLER**

SITE CIVIL AND CONSULTING ENGINEERING  
LANDSCAPE ARCHITECTURE  
PROGRAM MANAGEMENT  
SUSTAINABLE DESIGN  
TRANSPORTATION SERVICES

REVISIONS			
REV	DATE	COMMENT	DRAWN BY

**Sunshine811**

Call 811 or visit [sunshine811.com](http://sunshine811.com) two full business days before digging to have buried facilities located and marked.  
Check positive response codes before you dig!

ISSUED FOR MUNICIPAL & AGENCY REVIEW & APPROVAL

THIS DRAWING IS INTENDED FOR MUNICIPAL AND/OR AGENCY REVIEW AND APPROVAL. IT IS NOT INTENDED AS A CONSTRUCTION DOCUMENT UNLESS INDICATED OTHERWISE.

PROJECT No.: FLE240130.00-0A  
DRAWN BY: GD  
CHECKED BY: BW  
DATE: 09/11/2024  
CAD ID: P-CIVIL-LAND

PROJECT:

**PROP.  
SITE PLAN  
DOCUMENTS**  
FOR  
**POMPANO  
PICKLE, LLC**

PROPOSED  
DEVELOPMENT  
210-217 NE 3RD STREET  
POMPANO BEACH, FL  
BROWARD COUNTY

**BOHLER**

1900 NW CORPORATE BOULEVARD  
SUITE 101E  
BOCA RATON, FLORIDA 33431  
Phone: (561) 571-0280  
Fax: (561) 571-0281  
FLORIDA BUSINESS CERT. OF AUTH. No. 30780

THIS ITEM HAS BEEN DIGITALLY SIGNED AND SEALED BY BRETT MICHAEL WALDMAN, P.E., ON THE DATE ADJACENT TO THE SEAL. PRINTED COPIES OF THIS DOCUMENT ARE NOT CONSIDERED SIGNED AND SEALED AND THE SIGNATURE MUST BE VERIFIED ON ANY ELECTRONIC COPIES.

SHEET TITLE:

**LANDSCAPE  
PLAN**

SHEET NUMBER:  
**C-101**

DATE: 09/11/2024

**PZ24-12000019**

**11/06/2024**

THIS PLAN TO BE UTILIZED  
FOR SITE LAYOUT PURPOSES  
ONLY